

INDEX OF ROADWAY PLANS

SHEET NO.	SHEET DESCRIPTION
1	KEY SHEET
1A	SIGNATURE SHEET
2	GENERAL NOTES
3	EXISTING SURVEY - VENETIAN DRIVE
4	EXISTING SURVEY - GLEASON STREET
5	ROADWAY PLAN - VENETIAN DRIVE
6	ROADWAY PLAN - GLEASON STREET
7	SPECIAL DETAILS
8 - 9	STORM WATER POLLUTION PREVENTION PLAN

EAST ATLANTIC AVENUE (SR 806) CROSSWALK IMPROVEMENTS CITY OF DELRAY BEACH PALM BEACH COUNTY FLORIDA

SR 806 (ATLANTIC AVENUE) AT VENETIAN DRIVE
SR 806 (ATLANTIC AVENUE) AT GLEASON STREET

Project No. 14-008

GOVERNING STANDARDS AND SPECIFICATIONS:
FLORIDA DEPARTMENT OF TRANSPORTATION,
DESIGN STANDARDS FY 2017-2018,
AND STANDARD SPECIFICATIONS FOR ROAD AND
BRIDGE CONSTRUCTION DATED JANUARY 2017,
AS AMENDED BY CONTRACT DOCUMENTS.

APPLICABLE DESIGN STANDARDS MODIFICATIONS: 01-01-16

FOR DESIGN STANDARDS MODIFICATIONS CLICK ON
"DESIGN STANDARDS" AT THE FOLLOWING WEB SITE:
<http://www.dot.state.fl.us/rddesign/>

REVISIONS

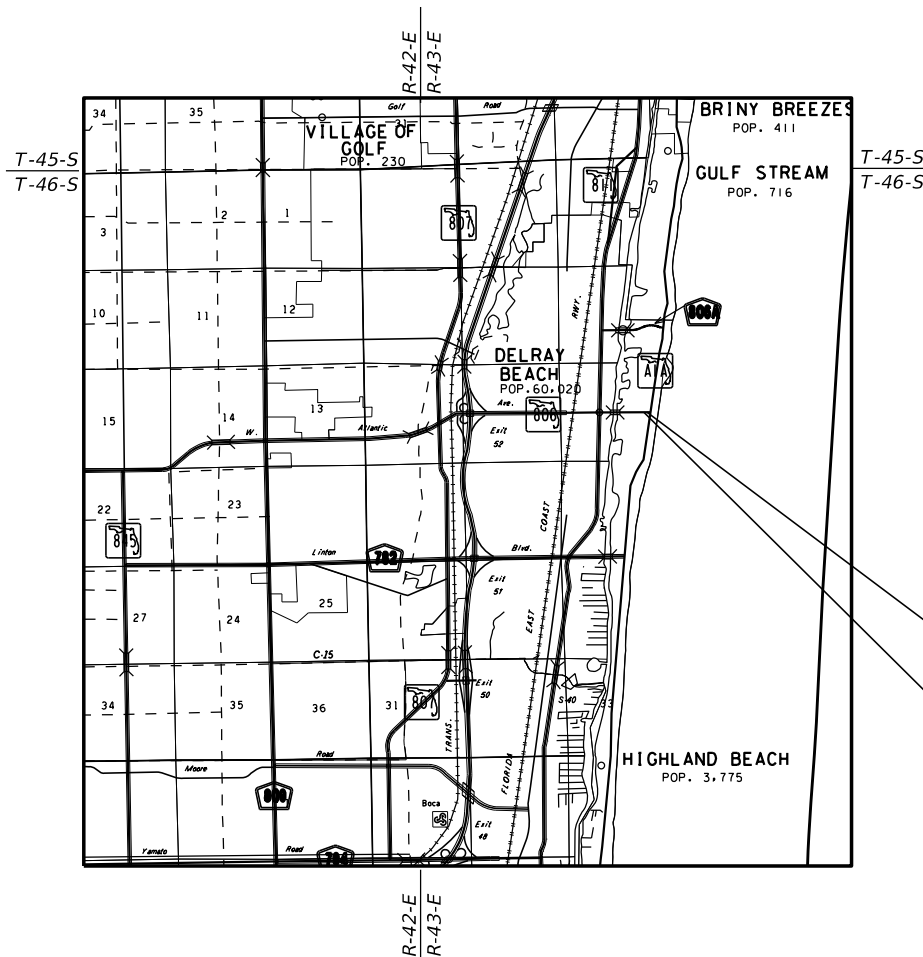

DESIGN SPEED 35 MPH
POSTED SPEED 25 MPH

PERMIT NO. 16C-496-0001-93030

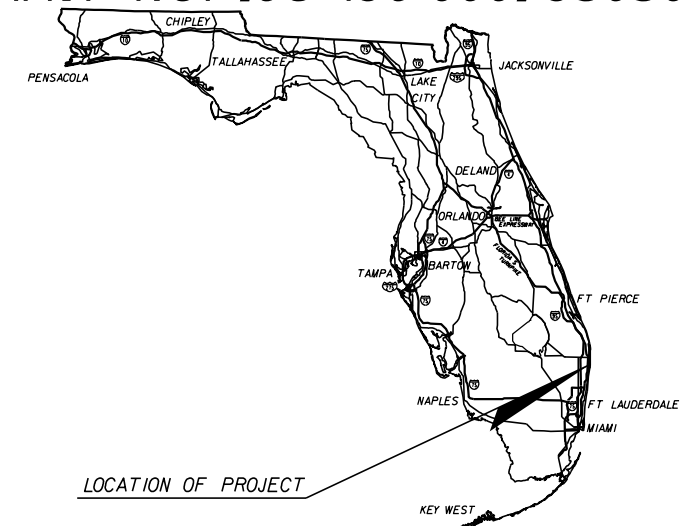

Mayor
Vice-Mayor
Deputy Vice-Mayor
Commissioner
Commissioner
City Manager

Shelly Petrolia
Adam Frankel
Shirley Johnson
Ryan Boylston
Bill Bathurst
Mark Lauzier

CRA Chair
CRA Vice Chair
CRA First Vice Chair
CRA Treasurer
CRA Board Member
CRA Board Member
CRA Board Member
Legal

Shelly Petrolia
Shirley Ervin Johnson
Angie Gray
Bill Bathurst
Ryan Boylston
Pamela Brinson
Adam Frankel
Goren, Cherof,
Doody and Ezrol

ROADWAY SHOP DRAWINGS
TO BE SUBMITTED TO:

KIMLEY-HORN AND ASSOCIATES, INC.
MARWAN MUFLEH, P.E.
SUITE 200
1920 WEKIVA WAY
WEST PALM BEACH, FLORIDA 33411

PLANS PREPARED BY:

KIMLEY-HORN AND ASSOCIATES, INC.
CONSULTING ENGINEERS AND PLANNERS
SUITE 200
1920 WEKIVA WAY
WEST PALM BEACH, FLORIDA 33411
PHONE (561) 845-0665
FAX (561) 863-8175
CONTRACT NO. C-8R82
VENDOR NUMBER: F560885615-001
CERTIFICATE OF AUTHORIZATION NO. 696

NOTE: THE SCALE OF THESE PLANS MAY
HAVE CHANGED DUE TO REPRODUCTION.

ROADWAY PLANS
ENGINEER OF RECORD: MARWAN MUFLEH, P.E.

P.E. NO. 45329



CITY of DELRAY BEACH
ENVIRONMENTAL SERVICES DEPARTMENT
434 SOUTH SWINTON AVENUE, DELRAY BEACH, FLORIDA 33444
Phone: (561) 243-7322 Fax: (561) 243-7314 www.mydelraybeach.com

ENGINEER'S SEAL MARWAN MUFLEH, P.E. 45329	KEY SHEET	PROJECT NO. 14-008 SHEET NO. 1 FILE ID.
---	-----------	---

ROADWAY PLANS

SHEET NO.	SHEET DESCRIPTION
1	KEY SHEET
1A	SIGNATURE SHEET
2	GENERAL NOTES
5	ROADWAY PLAN - VENETIAN DRIVE
6	ROADWAY PLAN - GLEASON STREET
7	SPECIAL DETAILS
8-9	STORM WATER POLLUTION PREVENTION PLANS

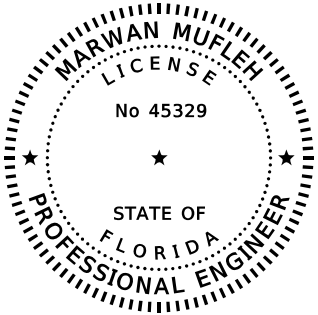

THIS DOCUMENT HAS BEEN DIGITALLY
SIGNED AND SEALED BY:

PRINTED COPIES OF THIS DOCUMENT ARE
NOT CONSIDERED SIGNED AND SEALED.
THE SIGNATURE MUST BE VERIFIED ON
THE ELECTRONIC DOCUMENTS.

Kimley-Horn and Associates, Inc.

Certificate Of Authorization No. 696
Marwan Mufleh, P.E.
P.E. License No. 45329
1920 Wekiva Way, Suite 200
West Palm Beach, Florida 33411

THE ABOVE NAMED PROFESSIONAL ENGINEER SHALL BE RESPONSIBLE FOR THE
FOLLOWING SHEETS IN ACCORDANCE WITH 61G15-23.004, F.A.C.

ROADWAY PLANS

SHEET NO.	SHEET DESCRIPTION
3	EXISTING SURVEY - VENETIAN DRIVE
4	EXISTING SURVEY - GLEASON STREET

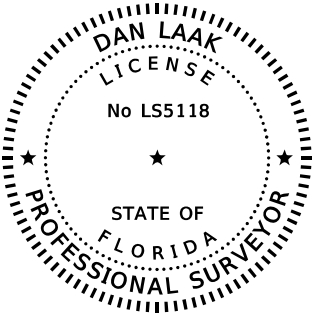

THIS DOCUMENT HAS BEEN DIGITALLY
SIGNED AND SEALED BY:

PRINTED COPIES OF THIS DOCUMENT ARE
NOT CONSIDERED SIGNED AND SEALED.
THE SIGNATURE MUST BE VERIFIED ON
THE ELECTRONIC DOCUMENTS.

HSQ Group, Inc.

Certificate Of Authorization No. 26258
Dan Laak, P.S.M.
P.S.M. License No. LS5118
1489 West Palmetto Park Road, Suite 340
Boca Raton, Florida 33486

THE ABOVE NAMED PROFESSIONAL SURVEYOR AND MAPPER SHALL BE RESPONSIBLE FOR THE
FOLLOWING SHEETS IN ACCORDANCE WITH 5J-17.062 F.A.C.



CITY of DELRAY BEACH
ENVIRONMENTAL SERVICES DEPARTMENT
434 SOUTH SWINTON AVENUE, DELRAY BEACH, FLORIDA 33444
Phone: (561) 243-7322 Fax: (561) 243-7314 www.mydelraybeach.com

KIMLEY-HORN AND ASSOCIATES, INC.
Certificate Of Authorization No. 696
MARWAN MUFLEH, P.E.
P.E. License No. 45329
Suite 200
1920 Wekiva Way
West Palm Beach, Florida 33411

ENGINEER'S SEAL

MARWAN MUFLEH, P.E.
45329

DESIGNED BY	G. NG				
DRAWN BY	S. BUKOVICH				
CHECKED BY	S. ORR				
DATE		REVISION	DATE	DESCRIPTION	BY

SIGNATURE SHEET

PROJECT NO.
14-008
SHEET NO.
1A
FILE ID.

GENERAL NOTES

1. ALL ELEVATIONS ARE REFERENCED FROM THE 1929 NGVD DATUM.
2. THE CONTRACTOR SHALL NOTIFY UTILITY OWNERS THROUGH SUNSHINE STATE ONE CALL OF FLORIDA. THE ENGINEER SHOULD NOTIFY THE DISTRICT LOCATION SURVEYOR, WITHOUT DELAY, BY TELEPHONE AT (954) 777-2287.
3. ALL STATION AND OFFSETS ARE FROM THE ~~8~~ SURVEY SR 806 (ATLANTIC AVENUE).
4. THE CONTRACTOR SHALL COORDINATE SELECTION AND REVIEW OF ANY PROPOSED STAGING AREAS ASSOCIATED WITH THE PROJECT WITH THE DISTRICT CONSTRUCTION ENVIRONMENTAL COORDINATOR AT (954) 777-4665.
5. PRIOR TO BEGINNING CONSTRUCTION, CONTRACTOR SHALL CONTACT THE PBC TRAFFIC OPERATIONS SUPERINTENDENT, (561) 233-3900, TO INFORM THEM OF CONSTRUCTION OPERATIONS.
6. THE CONTRACTOR IS ADVISED THAT SR A1A IS IN AN AREA OF RESTRICTIVE LIGHTING. NO BEACH ILLUMINATION WILL BE PERMITTED DURING SEA TURTLE NESTING SEASON (MARCH 1 THROUGH OCTOBER 31). SHOULD NIGHT CONSTRUCTION BE NECESSARY DURING THOSE MONTHS, PLEASE CONTACT THE DISTRICT CONSTRUCTION ENVIRONMENTAL COORDINATOR (DCEC) AT (954) 777-4665 TO ENSURE THAT TEMPORARY LIGHTING WILL NOT IMPACT SEA TURTLE NESTING.
7. AS PART OF AN FDOT CONSTRUCTION PROJECT, ANY PRIVATELY OWNED IRRIGATION SYSTEMS FOUND INSIDE FDOT RIGHT-OF-WAY SHALL BE CAPPED BY THE CONTRACTOR WHERE THIS SYSTEM IS IMPACTED BY THE PROJECT CONSTRUCTION LIMITS, AS DIRECTED BY FDOT PROJECT ENGINEER. IT SHALL BE THE RESPONSIBILITY OF THE CONTRACTOR TO NOTIFY THE ADJACENT PROPERTY OWNERS AT LEAST 30 DAYS IN ADVANCE, WHERE THE IRRIGATION SYSTEMS ARE FOUND TO ENSURE ALL SALVAGEABLE MATERIAL CAN BE RETRIEVED BY THE PROPERTY OWNER PRIOR TO CONSTRUCTION. IT WILL BE THE RESPONSIBILITY OF THE PROPERTY OWNER TO REPAIR, CONSTRUCT OR REPLACE THE IRRIGATION SYSTEMS WITHIN FDOT RIGHT-OF-WAY CAPPED OR DAMAGED DURING THE CONSTRUCTION OPERATIONS.
8. ALL EROSION CONTROL MEASURES SHALL BE REMOVED WHEN THEY ARE NO LONGER NEEDED OR WHEN DIRECTED BY THE ENGINEER.
9. CONTRACTOR SHALL SUBMIT A DETAILED MAINTENANCE OF TRAFFIC PLAN TO FDOT FOR THEIR APPROVAL FOUR WEEKS PRIOR TO COMMENCEMENT OF CONSTRUCTION. MAINTENANCE OF TRAFFIC SHALL BE IN ACCORDANCE WITH CURRENT FLORIDA D.O.T. STANDARDS, ESPECIALLY INDEX NO. 600 SERIES OF THE DESIGN STANDARDS AND THE CURRENT EDITION OF "MANUAL OF UNIFORM TRAFFIC CONTROL DEVICES." NO FULL ROAD CLOSURES WILL BE PERMITTED ON ATLANTIC AVE. CONTRACTOR SHALL MAINTAIN ONE LANE OF TRAFFIC IN EACH DIRECTION ON ATLANTIC AVE. TEMPORARY ROAD CLOSURE OF SIDE STREETS MAYBE ALLOWED FOR SHORT PERIODS OF TIME WITH ENGINEERS' APPROVAL. CONTRACTOR SHALL SUBMIT A DETAILED DETOUR PLAN SHOWING ALL PROPOSED SIGNS FOR ENGINEER'S APPROVAL AT LEAST FOUR WEEKS PRIOR TO START OF ROAD CLOSURE. CONTRACTOR MUST COORDINATE ALL TRAFFIC CHANGES WITH POLICE AND FIRE DEPARTMENTS. INSIDE LANE WORK / CLOSURES SHALL COMPLY WITH FDOT STANDARD INDEX NO. 615.
10. ALL RAMPS SHALL RECEIVE TRUNCATED DOMES PER FDOT INDEX 304.
11. MAINTENANCE OF TRAFFIC M.O.T. FOR THIS PROJECT WILL COMPLY WITH THE FLORIDA DEPARTMENT OF TRANSPORTATION DESIGN STANDARD INDEX (600 SERIES) AND THE LATEST EDITION OF THE MANUAL ON UNIFORM TRAFFIC CONTROL DEVICES (MUTCD). SPECIAL ATTENTION WILL BE GIVEN TO FDOT DESIGN STANDARD INDEX 611, 612, 613, AND 660.
12. PAVEMENT MARKINGS SHALL BE THERMOPLASTIC INSTALLED PER FDOT DESIGN STANDARD INDEX 17346. RAISED PAVEMENT MARKINGS (RPM'S) SHALL CONFORM TO FDOT DESIGN STANDARD INDEX 17352.
13. IT IS THE PERMITTEE'S RESPONSIBILITY TO OBTAIN FINAL ACCEPTANCE OF PERMITTED WORK (COMPLETED) AND THE RESTORATION OF THE RIGHT-OF-WAY FROM THE DEPARTMENT PRIOR TO USAGE.
14. PERMITTEE WILL RESTORE THE RIGHT OF WAY AS A MINIMUM, TO ITS ORIGINAL CONDITION OR BETTER IN ACCORDANCE W/ FLORIDA DEPARTMENT OF TRANSPORTATION'S LATEST STANDARD SPECIFICATIONS FOR ROAD & BRIDGE CONSTRUCTION OR AS DIRECTED BY THE RESIDENT OPERATIONS ENGINEER.
15. DURING THE REMOVAL/INSTALLATION OF ANY CURB AND GUTTER SECTION, THE PERMITTEE WILL BE RESPONSIBLE FOR ANY DAMAGE DONE TO THE ABUTTING ASPHALT. THE DAMAGED ASPHALT REPAIR WILL BE IN ACCORDANCE WITH THE CURRENT SPECIFICATIONS AND/OR AS DIRECTED BY THE RESIDENT OPERATIONS ENGINEER.
16. PERMITTEE SHALL PROVIDE THE PRODUCER'S CERTIFICATION (DELIVERY TICKET) FOR THE NS CONCRETE-2500 PSI (USED FOR SIDEWALK, CURB & GUTTER, DITCH PAVEMENT AND TRAFFIC SEPARATOR) PRIOR TO FINAL ACCEPTANCE BY THE DEPARTMENT. THE DELIVERY TICKET SHALL CERTIFY THE CONCRETE WAS BATCHED, DELIVERED AND PLACED IN ACCORDANCE WITH SECTION 347 OF THE DEPARTMENT'S STANDARD SPECIFICATIONS FOR ROAD AND BRIDGE CONSTRUCTION (CURRENT EDITION).
17. RESTRICTED HOURS OF OPERATION WILL BE FROM 9:00AM TO 3:30 PM, (MONDAY-FRIDAY), UNLESS OTHERWISE APPROVED BY THE OPERATIONS ENGINEER, OR DESIGNEE.
18. PERMITTEE WILL COORDINATE ALL WORK WITH DAVID MOORE OF BROADSPECTURM AT 954-317-8044, MOORED@TRANSFIELDSERVICES.COM. COORDINATION WILL INCLUDE A PRE-CONSTRUCTION MEETING.
19. ALL PUBLIC SIDEWALK CURB RAMPS WILL MEET THE ROADWAY & TRAFFIC DESIGN STANDARDS (CURRENT EDITION) INDEX NUMBER 304 CURB/RAMP INSPECTIONS (S) REQUIRED PRIOR TO INSTALLATION OF CONCRETE.
20. PERMIT IS VALID FOR ONE YEAR FROM DATE OF ISSUE.
21. PERMITTEE WILL PROVIDE THE DEPARTMENT WITH CERTIFIED "AS-BUILT" PLANS PRIOR TO FINAL ACCEPTANCE OF THE PERMITTED WORK.
22. REMOVAL/INSTALLATION OF SIDEWALK WILL BE IN ACCORDANCE WITH FDOT STANDARD INDEX 310.
23. PATTERNED PAVEMENT INSTALLATION SHALL COMPLY WITH CURRENT FDOT STANDARD SPECIFICATION 523. ONLINE REFERENCE: [HTTP://WWW.DOT.STATE.FL.US/PROGRAMMANAGEMENT/IMPLEMENTED/SPECBOOKS/JANUARY2016/FILES/523-116.PDF](http://www.dot.state.fl.us/programmanagement/implemented/specbooks/january2016/files/523-116.pdf).
24. CONTRACTOR SHALL AVOID ANY IMPACT TO EXISTING LANDSCAPING AND IRRIGATION AND MUST KEEP EXISTING IRRIGATION IN OPERATION AT ALL TIMES. ANY DAMAGE TO EXISTING LANDSCAPING OR IRRIGATION SHALL BE REPLACED IN KIND.

25. CONTRACTOR MAY BE REQUIRED TO PERFORM NIGHTTIME CONSTRUCTION ACTIVITIES AT NO ADDITIONAL COST.
26. CONTRACTOR SHALL COORDINATE WITH PALM BEACH COUNTY TRAFFIC REGARDING TEMPORARY SIGNALIZATION DURING CONSTRUCTION.

FDOT GENERAL NOTES

1. PRIOR TO ANY CONSTRUCTION, COORDINATE WITH FDOT TRAFFIC OPERATIONS AT 954-777-4079.
2. PERMITTEE WILL PROVIDE THE NECESSARY DENSITIES IN ACCORDANCE WITH SECTION 125-8 OF THE FDOT STANDARD SPECIFICATIONS FOR ROAD & BRIDGE CONSTRUCTION (LATEST EDITION) PRIOR TO FINAL ACCEPTANCE BY THE F.D.O.T
3. SODDED AREAS WILL BE IN ACCORDANCE WITH STANDARD INDEX 105 AND SECTIONS 162, 981, 982, 983, 987 OF THE F.D.O.T.'S STANDARD SPECIFICATIONS FOR ROAD AND BRIDGE CONSTRUCTION, LATEST EDITION. ALL DISTURBED AREAS WILL BE SODDED WITHIN ONE (1) WEEK OF INSTALLATION OF SAID PERMITTED WORK.
4. OWNERSHIP OF ALL SUITABLE EXCAVATED MATERIALS WITHIN THE FDOT R/W, AS DETERMINED BY THE F.D.O.T., SHALL REMAIN IN THE DEPARTMENT UNTIL A FINAL ACCEPTANCE OF THE PERMITTED PROJECT IS FULFILLED. EXCAVATED MATERIALS SHALL BE HAULED BY THE CONTRACTOR, AT THEIR COST & EXPENSE FROM THE SITE TO THE PALM BEACH OPERATIONS CENTER, 7900 W FOREST HILL BLVD OR STOCKPILED IN THOSE AREAS AS DIRECTED BY THE DOT, INCLUDING ASPHALT MILLINGS.
5. PERMITTEE'S CONTRACTORS THAT ARE PERFORMING PERMITTED WORK ACTIVITIES SHALL PROVIDE THE F.D.O.T. (PERMIT OFFICE) PROOF OF A PROPER STATE CONTRACTOR'S LICENSE AND CERTIFICATE OF LIABILITY INSURANCE PRIOR TO ANY COMMENCEMENT OF PERMITTED WORK



CITY of DELRAY BEACH
ENVIRONMENTAL SERVICES DEPARTMENT

434 SOUTH SWINTON AVENUE, DELRAY BEACH, FLORIDA 33444

Phone: (561) 243-7322 Fax: (561) 243-7314 www.mydelraybeach.com

KIMLEY-HORN AND ASSOCIATES, INC.

Certificate Of Authorization No. 696

MARWAN MUFLEH, P.E.

P.E. License No. 45329

Suite 200

1920 Wekiva Way
Gulf Breeze, Florida

West Palm Beach, Florida 33411

ENGINEER'S SEAL

MARWAN MUFLEH, P.E.
45329

DESIGNED BY	G. NG					GENERAL NOTES	PROJECT NO.	14-008
DRAWN BY	S. BUKOVICH						SHEET NO.	2
CHECKED BY	S. ORR						FILE ID.	
DATE		REVISION	DATE	DESCRIPTION	BY			

Brandon.Kern

1/10/2019

9:22:06 AM

K:\BCD_Roadway\044300027_Atlantic_Xwalk\000000_RoadwayPlans\Roadway\GNNTRD01.DGN

THE OFFICIAL RECORD OF THIS SHEET IS THE ELECTRONIC FILE DIGITALLY SIGNED AND SEALED UNDER RULE 61G15-23.004, F.A.C.

BANKOFF PLAT
(PB 99, PG. 112)
PCN NO. 12434616G40010000

SEABREEZE PARK
(PB 4, PG. 31)

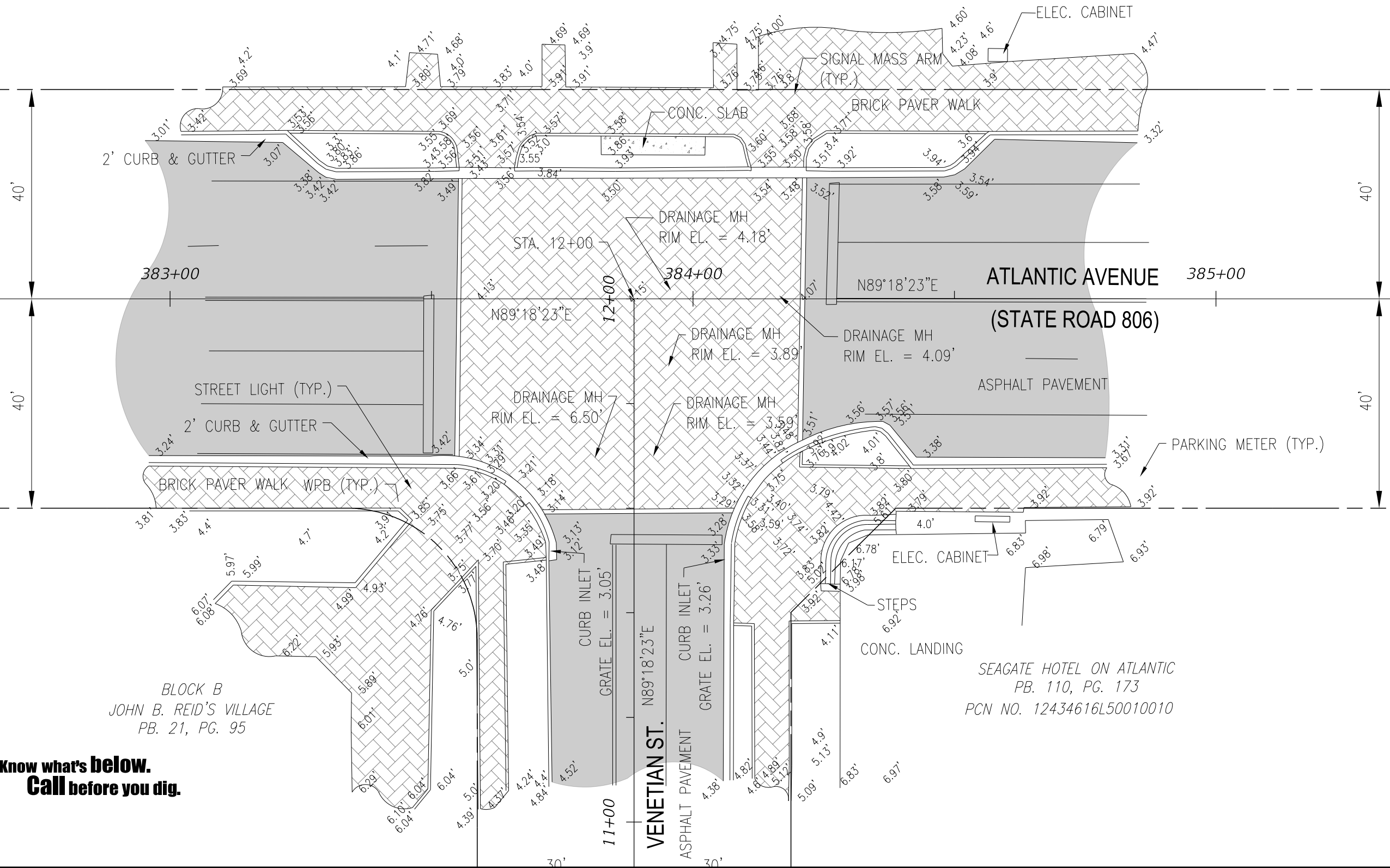

Know what's below.
Call before you dig.



CITY of DELRAY BEACH
ENVIRONMENTAL SERVICES DEPARTMENT
434 SOUTH SWINTON AVENUE, DELRAY BEACH, FLORIDA 33444
Phone: (561) 243-7322 Fax: (561) 243-7314 www.mydelraybeach.com

HSQ GROUP, INC.
Certificate Of Authorization No. 26258
DAN LAAK, P.S.M.
P.S.M. License No. LS5118
Suite 340
1489 West Palmetto Park Road
Boca Raton, Florida 33486

ENGINEER'S SEAL
MARWAN MUFLEH, P.E.
45329

DESIGNED BY	G. NG				
DRAWN BY	S. BUKOVICH				
CHECKED BY	J. SUMISLASKI				
DATE		REVISION	DATE	DESCRIPTION	BY

EXISTING SURVEY
VENETIAN DRIVE

PROJECT NO.
14-008
SHEET NO.
3
FILE ID.

PCN NO. 12434616710000000

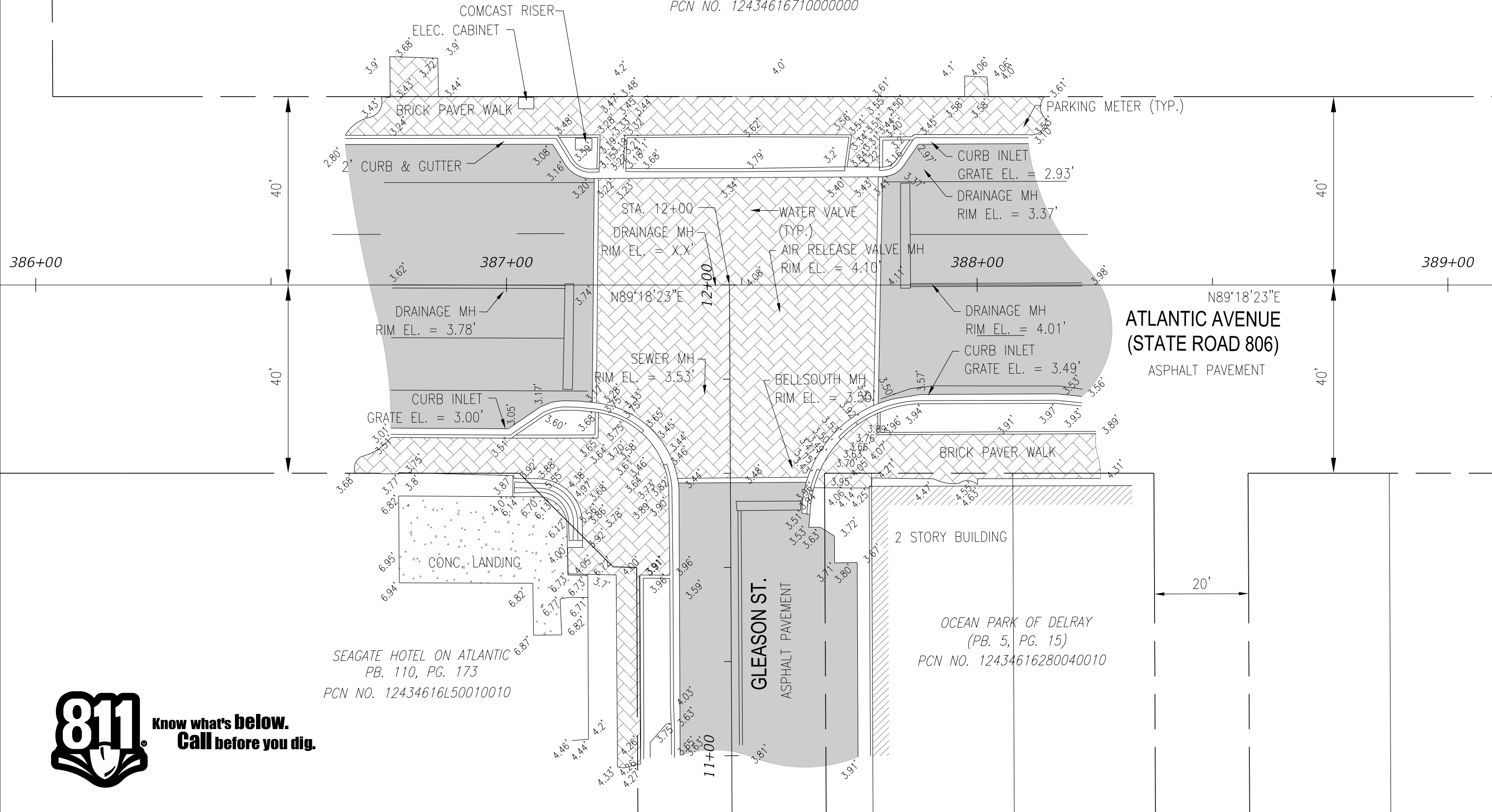

**Know what's below.
Call before you dig.**



CITY of DELRAY BEACH
ENVIRONMENTAL SERVICES DEPARTMENT
 434 SOUTH SWINTON AVENUE, DELRAY BEACH, FLORIDA 33444
 Phone: (561) 243-7322 Fax: (561) 243-7314 www.mydelraybeach.com

HSQ GROUP, INC.
Certificate Of Authorization No. 26258
DAN LAAK, P.S.M.
P.S.M. License No. LS5118
Suite 340
1489 West Palmetto Park Road
Boca Raton, Florida 33486

ENGINEER'S SEAL

MARWAN MUFLEH, P.E.

45329

DESIGNED BY	G. NG				
DRAWN BY	S. BUKOVICH				
CHECKED BY	S. ORR				
DATE		REVISION	DATE	DESCRIPTION	BY

EXISTING SURVEY
GLEASON STREET

PROJECT NO.
14-008

SHEET NO.
4

FILE ID.

THE OFFICIAL RECORD OF THIS SHEET IS THE ELECTRONIC FILE DIGITALLY SIGNED AND SEALED UNDER RULE 5J-17.062, F.A.C.

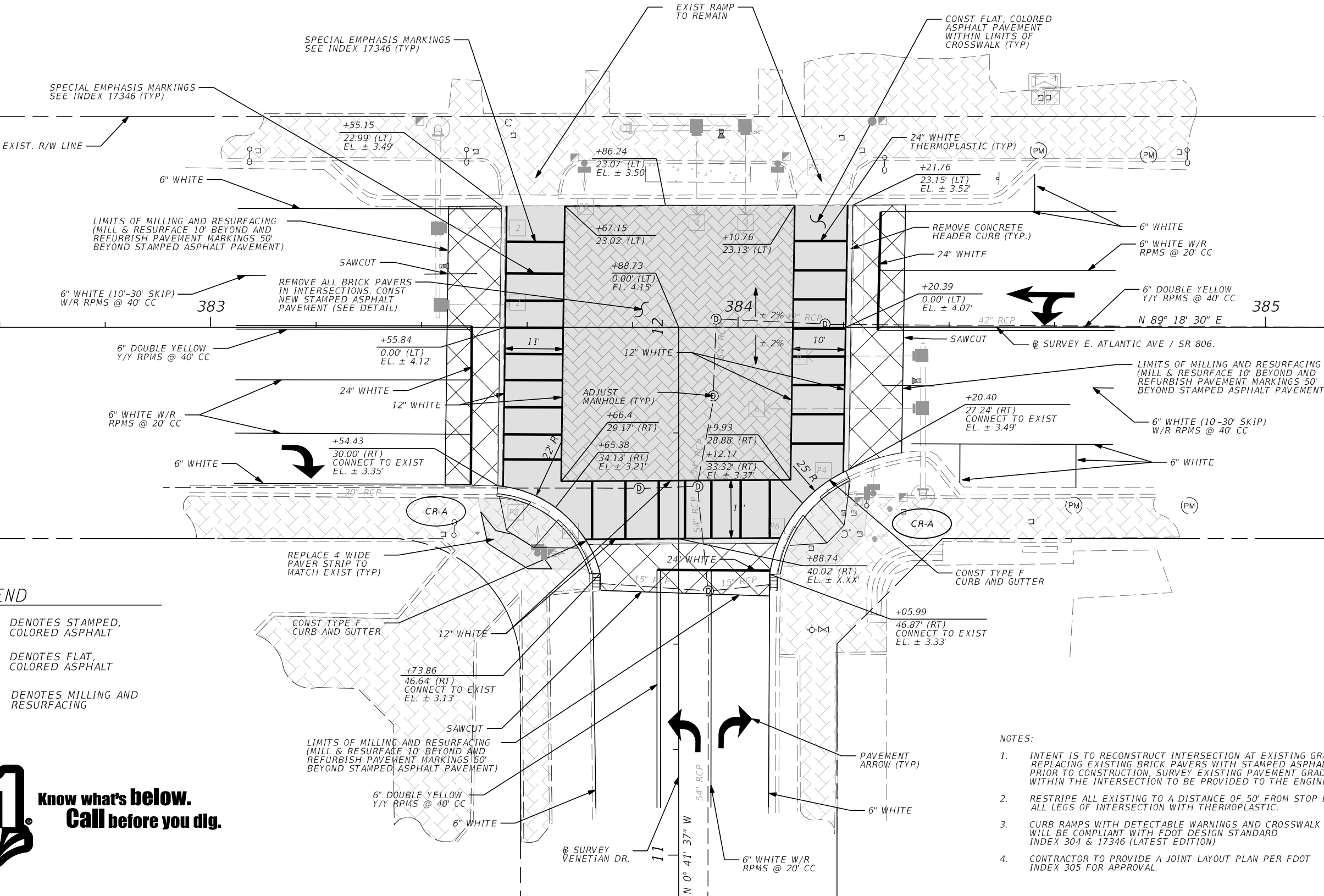
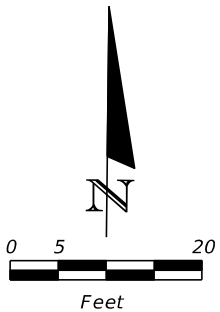

LEGEND

- DENOTES STAMPED, COLORED ASPHALT
- DENOTES FLAT, COLORED ASPHALT
- DENOTES MILLING AND RESURFACING



- NOTES:
- INTENT IS TO RECONSTRUCT INTERSECTION AT EXISTING GRADE BY REPLACING EXISTING BRICK PAVERS WITH STAMPED ASPHALT. PRIOR TO CONSTRUCTION, SURVEY EXISTING PAVEMENT GRADES WITHIN THE INTERSECTION TO BE PROVIDED TO THE ENGINEER.
 - RESTRIPE ALL EXISTING TO A DISTANCE OF 50' FROM STOP BAR ON ALL LEGS OF INTERSECTION WITH THERMOPLASTIC.
 - CURB RAMPS WITH DETECTABLE WARNINGS AND CROSSWALK WILL BE COMPLIANT WITH FDOT DESIGN STANDARD INDEX 304 & 17346 (LATEST EDITION)
 - CONTRACTOR TO PROVIDE A JOINT LAYOUT PLAN PER FDOT INDEX 305 FOR APPROVAL.



CITY of DELRAY BEACH
ENVIRONMENTAL SERVICES DEPARTMENT
434 SOUTH SWINTON AVENUE, DELRAY BEACH, FLORIDA 33444
Phone: (561) 243-7322 Fax: (561) 243-7314 www.mydelraybeach.com

KIMLEY-HORN AND ASSOCIATES, INC.
Certificate Of Authorization No. 696
MARWAN MUFLEH, P.E.
P.E. License No. 45329
Suite 200
1920 Wekiva Way
West Palm Beach, Florida 33411

ENGINEER'S SEAL
MARWAN MUFLEH, P.E.
45329

DESIGNED BY	G. NG				
DRAWN BY	S. BUKOVICH				
CHECKED BY	J. SUMISLASKI				
DATE		REVISION	DATE	DESCRIPTION	BY

ROADWAY PLAN
VENETIAN DRIVE

PROJECT NO.	14-008
SHEET NO.	5
FILE ID.	

THE OFFICIAL RECORD OF THIS SHEET IS THE ELECTRONIC FILE DIGITALLY SIGNED AND SEALED UNDER RULE 61G15-23.004, F.A.C.

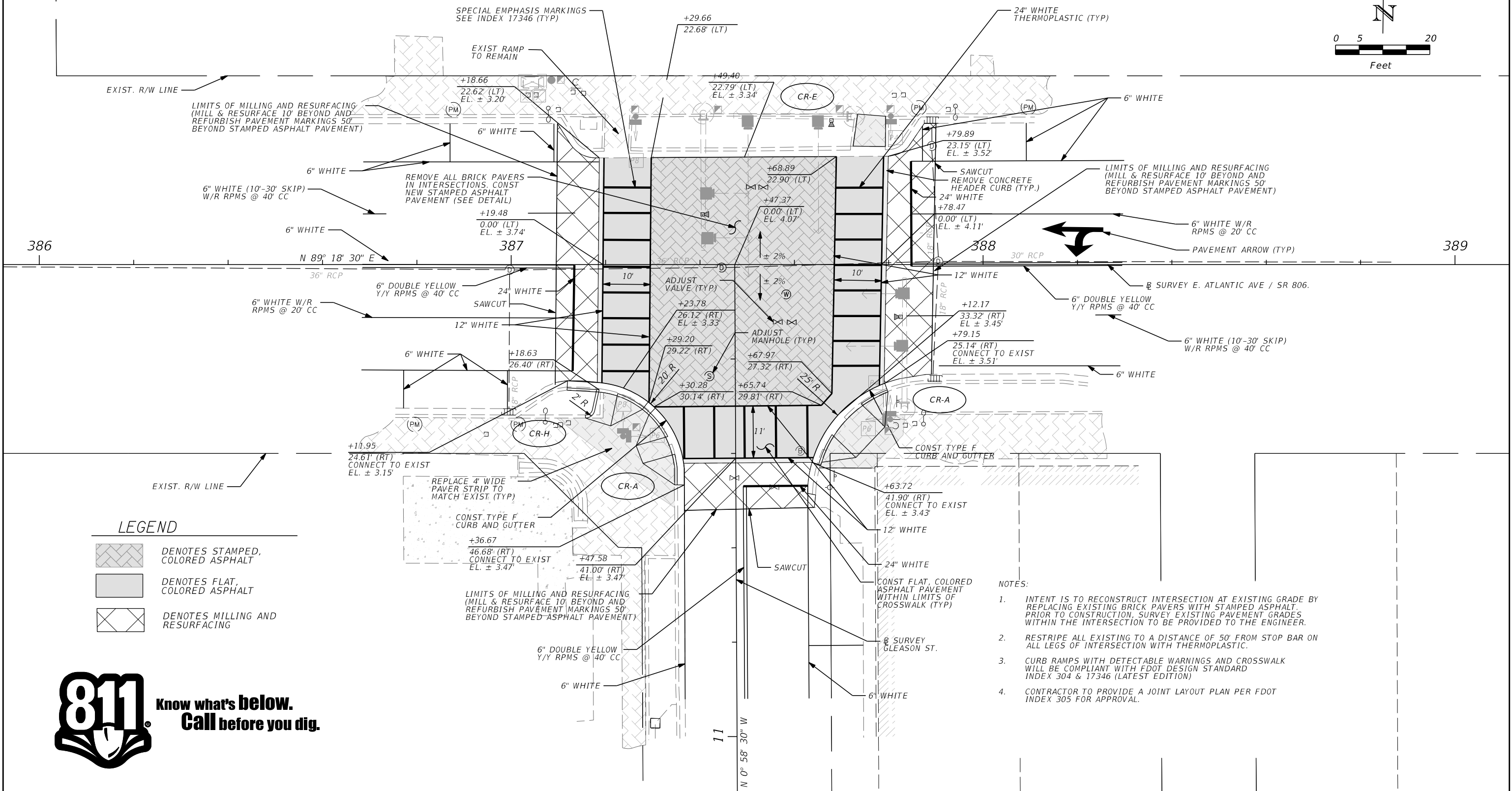
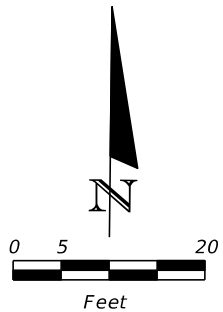

LEGEND

- DENOTES STAMPED, COLORED ASPHALT
- DENOTES FLAT, COLORED ASPHALT
- DENOTES MILLING AND RESURFACING

- NOTES:
- INTENT IS TO RECONSTRUCT INTERSECTION AT EXISTING GRADE BY REPLACING EXISTING BRICK PAVERS WITH STAMPED ASPHALT. PRIOR TO CONSTRUCTION, SURVEY EXISTING PAVEMENT GRADES WITHIN THE INTERSECTION TO BE PROVIDED TO THE ENGINEER.
 - RESTRIPE ALL EXISTING TO A DISTANCE OF 50' FROM STOP BAR ON ALL LEGS OF INTERSECTION WITH THERMOPLASTIC.
 - CURB RAMPS WITH DETECTABLE WARNINGS AND CROSSWALK WILL BE COMPLIANT WITH FDOT DESIGN STANDARD INDEX 304 & 17346 (LATEST EDITION)
 - CONTRACTOR TO PROVIDE A JOINT LAYOUT PLAN PER FDOT INDEX 305 FOR APPROVAL.



Know what's below.
Call before you dig.



CITY of DELRAY BEACH
ENVIRONMENTAL SERVICES DEPARTMENT
434 SOUTH SWINTON AVENUE, DELRAY BEACH, FLORIDA 33444
Phone: (561) 243-7322 Fax: (561) 243-7314 www.mydelraybeach.com

KIMLEY-HORN AND ASSOCIATES, INC.
Certificate Of Authorization No. 696
MARWAN MUFLEH, P.E.
P.E. License No. 45329
Suite 200
1920 Wekiva Way
West Palm Beach, Florida 33411

ENGINEER'S SEAL
MARWAN MUFLEH, P.E.
45329

DESIGNED BY	G. NG				
DRAWN BY	S. BUKOVICH				
CHECKED BY	S. ORR				
DATE		REVISION	DATE	DESCRIPTION	BY

ROADWAY PLAN
GLEASON STREET

PROJECT NO.
14-008
SHEET NO.
6
FILE ID.



1. STAMPED ASPHALT WILL BE 45° HERRINGBONE RED. FLAT COLORED ASPHALT PAVEMENT WILL BE THE COLOR RED. APPLY COLOR-MATCHED RELEASE AGENT TO ALL COLORED ASPHALT SURFACES.
2. INDEPENDENT TEST DATA VERIFYING THE PAVEMENT MEETS FRICTION REQUIREMENTS IN ACCORDANCE WITH EITHER:
 - A. ASTM E-274, SKID RESISTANCE OF PAVED SURFACES USING A STANDARD RIBBED FULL SCALE TIRE AT A SPEED OF 40 MPH (FN40R), AND HAS A MINIMUM FN40R VALUE OF 35, OR
 - B. ASTM E- 1911, MEASURING PAVED SURFACE FRICTIONAL PROPERTIES USING THE DYNAMIC FRICTION TESTER (DFT), AT A SPEED OF 40 MPH (DFT40), AND HAS A MINIMUM DFT40 VALUE OF 40.
3. CONTRACTOR WILL SUBMIT A SHOP DRAWING FOR APPROVAL OF STAMPED ASPHALT, COLOR AND MIX PRODUCTS, AND RELEASE AGENTS.
4. PRIOR TO INSTALLATION, FURNISH A 10' X 10' SAMPLE SHOWING COLOR, STAMPED FINISH, AND TEXTURE FOR CONFIRMATION THAT THE PRODUCT MEETS THE PATTERN AND COLOR SPECIFIED IN THE PLANS. DO NOT BEGIN INSTALLATION UNTIL ACCEPTANCE BY THE ENGINEER.



ASPHALT FRICTION COURSE: 1.5" ASPHALT FRICTION COURSE, FDOT TYPE FD-12.5.
FRICTION COURSE SHALL CONFORM TO THE REQUIREMENTS OF
FDOT STANDARD SPECIFICATIONS SECTIONS 330 & 331.

ASPHALT STRUCTURE COURSE: 2.5" ASPHALT STRUCTURE COURSE, FDOT TYPE SP-12.5.
FRICTION COURSE SHALL CONFORM TO THE REQUIREMENTS OF
FDOT STANDARD SPECIFICATIONS SECTIONS 330 & 331.

PRIME & TACK COAT: PRIME & TACK COAT FOR THE BASE COURSE SHALL
CONFORM TO THE REQUIREMENTS OF FDOT STANDARD
SPECIFICATIONS SECTION 300.
APPLICATION RATES - PRIME COAT-0.25 GALLONS PER SQ. YD.
TACK COAT-0.08 GALLONS PER SQ. YD.

BASE: 15" LIMEROCK BASE
MINIMUM LBR = 100
COMPACTED TO 98% MAXIMUM DENSITY (AASHTO T-180).
BASE TO CONFORM TO THE REQUIREMENTS OF
FDOT SPECIFICATION SECTIONS 200 & 911.

SUBBASE: 12" SUBBASE
MINIMUM LBR = 40
COMPACTED TO 98% MAXIMUM DENSITY (AASHTO T-180).
SUBBASE TO CONFORM TO THE REQUIREMENTS OF
FDOT SPECIFICATION SECTIONS 200 & 911.

MILL EXISTING ASPHALT PAVEMENT (1.5" AVG. DEPTH)

FRICION COURSE FC-12.5 (1.5") (TRAFFIC LEVEL C) (PG 76-22)



ENGINEER'S SEAL

MARWAN MUFLEH, P.E.

45329

SPECIAL DETAILS

PROJECT NO.	14-008
SHEET NO.	7
FILE ID.	

1.0 SITE DESCRIPTION

1.A. NATURE OF CONSTRUCTION ACTIVITIES:

THIS PROJECT IS A RECONSTRUCTION PROJECT OF TWO BRICK PAVER INTERSECTIONS ALONG EAST ATLANTIC AVENUE (SR 806) THAT HAVE EXPERIENCED SETTLING. THE INTERSECTIONS ARE ATLANTIC AVENUE (SR 806) AT VENETIAN DRIVE, AND ATLANTIC AVENUE (SR 806) AT GLEASON STREET. THE EXISTING BRICK PAVER INTERSECTION WILL BE REMOVED AND REPLACED WITH A NEW STAMPED ASPHALT PAVEMENT STRUCTURE. SUBSTANDARD PEDESTRIAN RAMPS AT THE INTERSECTIONS WILL ALSO BE REPLACED WITH NEW BRICK PAVERS RAMPS, DESIGNED TO MEET ADA STANDARDS. THE INTERSECTIONS WILL ALSO INCLUDE REPLACING THE EXISTING CROSSWALKS AS PART OF THE RECONSTRUCTION OF THE PAVEMENT STRUCTURE.

THIS PROJECT DOES NOT INCLUDE ANY CHANGES IN ROADWAY GEOMETRY.

1. B. SEQUENCE OF MAJOR SOIL DISTURBING ACTIVITIES:

- 1. REMOVE EXISTING BRICK PAVER PAVEMENT STRUCTURES AND PEDESTRIAN RAMPS.
- 2. CONSTRUCT NEW PAVEMENT STRUCTURES AND PEDESTRIAN RAMPS.

1.C. AREA ESTIMATES:

TOTAL SITE AREA: 1.7 AC
TOTAL AREA TO BE DISTURBED: 0.4 AC
TOTAL AREA OF CLEARING AND GRUBBING: 0.4 AC
NEW IMPERVIOUS: 0.00 AC

1.D. QUALITY OF EXISTING STORMWATER DISCHARGE:

A SOIL SURVEY IS NOT INCLUDED ON THE CONSTRUCTION PLANS.

1.E. SITE MAP:

THE FOLLOWING INFORMATION IS SHOWN ON THE SPECIFIC PLANS NOTED BELOW.

AREAS OF SOIL DISTURBANCE: THE AREAS TO BE DISTURBED ARE INDICATED ON THE PLAN SHEETS AND SPECIAL DETAIL SHEETS. ANY AREAS WHERE PERMANENT FEATURES WILL BE CONSTRUCTED ABOVE OR BELOW THE GROUND WILL BE DISTURBED.

AREAS NOT TO BE DISTURBED: AREAS OUTSIDE THE PROPOSED CONSTRUCTION WITHIN THE PROJECT LIMITS WILL NOT BE DISTURBED DURING CONSTRUCTION.

LOCATION OF CONTROLS: TEMPORARY SEDIMENT CONTROL DEVICES (INLET PROTECTION SYSTEM AND SEDIMENT BARRIER) WILL BE INSTALLED AROUND THE INLETS . SEDIMENT BARRIER SHALL BE INSTALLED AT ALL CONSTRUCTION BOUNDARIES WHERE STORMWATER RUNOFF HAS THE POTENTIAL TO REACH SURFACE WATERS OR OFF SITE STORMWATER COLLECTION FACILITIES.

AREAS TO BE STABILIZED: PERMANENT STABILIZATION IS SHOWN ON THE SPECIAL DETAIL SHEETS.

SURFACE WATERS: THERE ARE NO SURFACE WATERS WITHIN THE PROJECT CORRIDOR.

2.0 CONTROLS

2.A. EROSION AND SEDIMENT CONTROLS:

IN THE SECTION 104 EROSION CONTROL PLAN, THE CONTRACTOR SHALL DESCRIBE THE PROPOSED STABILIZATION AND STRUCTURAL PRACTICES BASED ON THE PROPOSED TRAFFIC CONTROL PLAN. THE FOLLOWING RECOMMENDED GUIDELINES ARE BASED ON THE TRAFFIC CONTROL PLANS. WHERE FOLLOWING THE TRAFFIC CONTROL PLANS OUTLINED IN THESE CONSTRUCTION PLANS, THE CONTRACTOR MAY CHOOSE TO ACCEPT THE FOLLOWING GUIDELINES OR MODIFY THEM IN THE SECTION 104 EROSION CONTROL PLAN, SUBJECT TO APPROVAL OF THE ENGINEER. AS WORK PROGRESSES, THE CONTRACTOR SHALL MODIFY THE PLAN TO ADAPT TO SEASONAL VARIATIONS, CHANGES IN CONSTRUCTION ACTIVITIES, AND THE NEED FOR BETTER PRACTICES.

2.A.1. STABILIZATION PRACTICES:

IN THE SECTION 104 EROSION CONTROL PLAN, THE CONTRACTOR SHALL DESCRIBE THE STABILIZATION PRACTICES PROPOSED TO CONTROL EROSION. THE CONTRACTOR

SHALL INITIATE ALL STABILIZATION MEASURES AS SOON AS PRACTICAL, BUT IN NO CASE MORE THAN 7 DAYS AFTER BEGINNING WORK.

THE STABILIZATION PRACTICES SHALL INCLUDE AT LEAST THE FOLLOWING, UNLESS OTHERWISE APPROVED BY THE ENGINEER.

TEMPORARY:

NO TEMPORARY STABILIZATION PRACTICES TO BE IMPLEMENTED

PERMANENT:

ASPHALT OR CONCRETE SURFACE
CONCRETE OR PAVER SIDEWALKS

2.A.2 STRUCTURAL PRACTICES:

IN THE SECTION 104 EROSION CONTROL PLAN, THE CONTRACTOR SHALL DESCRIBE THE PROPOSED STRUCTURAL PRACTICES TO CONTROL OR TRAP SEDIMENT AND OTHERWISE PREVENT THE DISCHARGE OF POLLUTANTS FROM EXPOSED AREAS OF THE SITE. SEDIMENT CONTROLS SHALL BE IN PLACE BEFORE DISTURBING SOIL UPSTREAM OF THE CONTROL. THE STRUCTURAL PRACTICES SHALL INCLUDE AT LEAST THE FOLLOWING, UNLESS OTHERWISE APPROVED BY THE ENGINEER.

TEMPORARY:

SEDIMENT BARRIER IN ACCORDANCE WITH DESIGN STANDARD INDEX 102.

INLET PROTECTION SYSTEM IN ACCORDANCE WITH DESIGN STANDARD INDEX 102.

PERMANENT:

PERFORMANCE TURF.

2.B. STORMWATER MANAGEMENT:

THE EXISTING STORM SEWER SYSTEM WILL BE MAINTAINED.

2.C. OTHER CONTROLS:

THE CONTRACTOR SHALL PRACTICE GOOD HOUSEKEEPING BY INSTITUTING A CLEAN, ORDERLY, CONSTRUCTION SITE. THE FOLLOWING CONTROLS SHALL BE IMPLEMENTED TO FURTHER REDUCE POLLUTION AT THE PROJECT SITE.



CITY of DELRAY BEACH
ENVIRONMENTAL SERVICES DEPARTMENT
434 SOUTH SWINTON AVENUE, DELRAY BEACH, FLORIDA 33444
Phone: (561) 243-7322 Fax: (561) 243-7314 www.mydelraybeach.com

KIMLEY-HORN AND ASSOCIATES, INC.
Certificate Of Authorization No. 696
MARWAN MUFLEH, P.E.
P.E. License No. 45329
Suite 200
1920 Wekiva Way
West Palm Beach, Florida 33411

ENGINEER'S SEAL

MARWAN MUFLEH, P.E.
45329

DESIGNED BY	G. NG
DRAWN BY	S. BUKOVICH
CHECKED BY	S. ORR
DATE	

REVISION	DATE	DESCRIPTION	BY		

PROJECT NO. 14-008
SHEET NO. 8
FILE ID.



NO CONSTRUCTION MATERIAL SHALL BE DISCHARGED TO WATERS OF THE STATE UNLESS AUTHORIZED BY SECTION 104 PERMIT AND/OR THE STATE OF FLORIDA ENVIRONMENTAL RESOURCE PERMIT. ALL CONSTRUCTION DEBRIS SHALL BE DISPOSED OF IN AN APPROVED UPLAND LOCATION. BUILDING MATERIAL SHALL NOT BE DISPOSED OF IN WETLANDS OR BURIED ON SITE.

THE CONTRACTOR SHALL TAKE MEASURES TO INSURE THE CLEANUP OF SEDIMENTS THAT HAVE BEEN TRACKED BY VEHICLES OR HAVE BEEN TRANSPORTED BY WIND OR STORM WATER ABOUT THE SITE OR ONTO NEARBY ROADWAYS.

LOADED HAUL TRUCKS SHALL BE COVERED WITH A TARPAULIN. EXCESS DIRT ON THE ROAD SHALL BE REMOVED DAILY.

THE CONTRACTOR SHALL DEMONSTRATE THE PROPER DISPOSAL OF ALL CONSTRUCTION WASTE GENERATED WITHIN THE PROJECT LIMITS. WASTE MAY INCLUDE, BUT NOT BE LIMITED TO, VEGETATION FROM CLEARING AND GRUBBING ACTIVITIES, PACKAGING MATERIALS, SCRAP BUILDING MATERIALS, LITTER FROM TRAVELING PUBLIC, SEWAGE FROM SANITARY FACILITIES, HERBICIDES AND PESTICIDES AND THEIR CONTAINERS, AND HYDROCARBON PRODUCTS. CONTRACTOR SHALL DESIGNATE A WASTE COLLECTION AREA ONSITE AND DELINEATE THE AREA ON THE SWPPP SITE MAP.

THE CONTRACTOR WILL PROVIDE LITTER CONTROL AND COLLECTION WITHIN THE PROJECT LIMITS DURING CONSTRUCTION ACTIVITIES. CONTRACTOR WILL PROVIDE AN ADEQUATE NUMBER OF LITTER CONTAINERS WITH LIDS AT THE STAGING, STOCKPILE AND FIELD OFFICE AREAS. SPILLED LITTER CONTAINERS WILL BE CLEANED UP IMMEDIATELY.

THE APPLICATION AND HANDLING OF HERBICIDES AND PESTICIDES SHALL BE IN COMPLIANCE WITH THE MANUFACTURER RECOMMENDED METHOD.

CONTRACTOR SHALL PROVIDE EQUIPMENT NECESSARY TO CONTAIN AND CLEAN UP SPILLS OF HAZARDOUS MATERIALS, INCLUDING PETROLEUM PRODUCTS. SPILLS SHALL BE CONTAINED AND CLEANED UP IMMEDIATELY AFTER THEY OCCUR. SPILLED MATERIAL AND THE EQUIPMENT USED TO CLEAN UP THE SPILL SHALL NOT COME IN CONTACT WITH SURFACE WATERS OR BE INTRODUCED INTO STORM WATER. DISPOSAL OF SURPLUS PRODUCT WILL BE DONE ACCORDING TO MANUFACTURER RECOMMENDED METHOD.

PETROLEUM PRODUCTS SHALL BE STORED IN COVERED AREAS WITH SECONDARY CONTAINMENT SURROUNDING CONTAINER.

THE CONTRACTOR SHALL PROVIDE A PLAN FOR MAINTAINING ALL EROSION AND SEDIMENT CONTROLS THROUGHOUT CONSTRUCTION. THE MAINTENANCE PLAN SHALL AT A MINIMUM, COMPLY WITH THE FOLLOWING.

SUMP INLETS: REMOVE SEDIMENT WHEN IT REACHES A DEPTH OF 1 FT IN SUMP.

PERFORMANCE TURF: KEEP THE PERFORMANCE TURF IN MOIST CONDITION FOR THE DURATION OF THE CONTRACT PERIOD AND IN NO CASE LESS THAN TWO WEEKS. TEMPORARY AND PERMANENT SODDING WILL BE INSPECTED AND REPAIRED FOR BARE SPOTS, WASHOUTS, AND UNHEALTHY GROWTH.

INLET PROTECTION SYSTEM: REMOVE SEDIMENT WHEN IT REACHES 1/3 THE HEIGHT OF THE BAG.

SEDIMENT BARRIER: REMOVE SEDIMENT WHEN IT REACHES 1/2 THE HEIGHT OF BALES OR WHEN WATER PONDS IN UNACCEPTABLE AMOUNTS OR AREAS. THE CONTRACTOR SHOULD ANTICIPATE REPLACING BALES ON 3-MONTH INTERVALS.

QUALIFIED PERSONNEL SHALL INSPECT THE FOLLOWING ITEMS AT LEAST ONCE EVERY SEVEN CALENDAR DAYS AND WITHIN 24 HOURS OF THE END OF A STORM THAT PRODUCES 0.50 INCHES OR MORE OF RAIN. WHERE SITES HAVE BEEN PERMANENTLY STABILIZED, INSPECTIONS SHALL BE CONDUCTED AT LEAST ONCE EVERY MONTH. THE CONTRACTOR SHALL ALSO INSPECT THAT CONTROLS INSTALLED IN THE FIELD AGREE WITH THE LATEST STORM WATER POLLUTION PREVENTION PLAN. THE FOLLOWING ITEMS WILL BE INSPECTED:

POINTS OF DISCHARGE TO SEPARATE MUNICIPAL STORM SEWER SYSTEMS.

DISTURBED AREAS OF THE SITE THAT HAVE NOT BEEN FINALLY STABILIZED.

AREAS USED FOR STORAGE OF MATERIALS THAT ARE EXPOSED TO PRECIPITATION.

STRUCTURAL CONTROLS.

STORMWATER MANAGEMENT SYSTEMS.

LOCATIONS WHERE VEHICLES ENTER OR EXIT THE SITE.

THE CONTRACTOR SHALL INITIATE REPAIRS WITHIN 24 HOURS OF INSPECTIONS THAT INDICATE ITEMS ARE NOT IN GOOD WORKING ORDER.

IF INSPECTIONS INDICATE THAT THE INSTALLED STABILIZATION AND STRUCTURAL PRACTICES ARE NOT SUFFICIENT TO MINIMIZE EROSION, RETAIN SEDIMENT, AND PREVENT DISCHARGING POLLUTANTS, THE CONTRACTOR SHALL PROVIDE ADDITIONAL MEASURES, AS APPROVED BY THE ENGINEER.

ANY KNOWN OR SUSPECT HAZARDOUS MATERIAL FOUND ON THE PROJECT BY THE CONTRACTOR SHALL BE IMMEDIATELY REPORTED TO THE PROJECT ENGINEER, WHO SHALL DIRECT THE CONTRACTOR TO PROTECT THE AREA OF KNOWN OR SUSPECT HAZARDOUS MATERIAL FROM FURTHER ACCESS. THE PROJECT ENGINEER IS TO NOTIFY THE PROPER REGULATORY AUTHORITY OF THE DISCOVERY. THE PROPER REGULATORY AUTHORITY WILL ADVISE / DIRECT THE PROJECT ENGINEER IN THE INVESTIGATION, IDENTIFICATION, AND / OR REMOVAL / REMEDIATION OF THE MATERIAL IN QUESTION AS NEEDED. THE CONTRACTOR SHALL NOT RETURN TO THE AREA OF SUSPECTED CONTAMINATION UNTIL APPROVAL IS PROVIDED BY THE PROJECT ENGINEER. THE REGULATORY AUTHORITY WILL ADVISE THE PROJECT ENGINEER IN THESE MATTERS.

ENGINEER'S SEAL

MARWAN MUFLEH, P.E.
45329

DESIGNED BY	G. NG					<p style="text-align: center;">STORM WATER POLLUTION PREVENTION PLAN</p>	PROJECT NO.	14-008
DRAWN BY	S. BUKOVICH						SHEET NO.	9
CHECKED BY	S. ORR						FILE ID.	
DATE		REVISION	DATE	DESCRIPTION	BY			

THE CONTRACTOR SHALL DEVELOP A PLAN TO DISPOSE OF SLURRY MATERIAL FROM THE INSTALLATION OF MAST ARM FOUNDATIONS. SEDIMENT REMOVED FROM SUMP INLETS DURING CONSTRUCTION SHALL BE DISPOSED OF IN DESIGNATED STOCKPILE LOCATIONS.

IT IS THE CONTRACTOR'S RESPONSIBILITY TO DESIGNATE AN AREA WITHIN THE PROJECT LIMITS FOR CONCRETE TRUCK WASHOUT ACTIVITIES. THIS AREA SHALL PROVIDE EROSION CONTROL DEVICES THAT PREVENT CONTACT BETWEEN CONCRETE WASHOUT MATERIALS AND STORMWATER AND/OR SURFACE WATERS.

6.0 CONTRACTOR SUBMITTAL:

IT IS THE RESPONSIBILITY OF THE CONTRACTOR TO DEVELOP AN EROSION CONTROL PLAN THAT PROVIDES A DETAILED DESCRIPTION OF ALL EROSION AND SEDIMENT CONTROLS, BEST MANAGEMENT PRACTICES, AND MEASURES THAT WILL BE IMPLEMENTED AT THE CONSTRUCTION SITE FOR EACH ACTIVITY IDENTIFIED IN SECTION I.B. SEQUENCE OF SOIL DISTURBING ACTIVITIES. THE CONTRACTOR IS RESPONSIBLE FOR PROVIDING TIME FRAMES IN WHICH THE CONTROLS WILL BE IMPLEMENTED, MAINTAINED AND REMOVED. THIS INFORMATION SHALL BE KEPT AT THE PROJECT FIELD OFFICE IN ORDER FOR THE PROJECT TO BE CONSIDERED IN COMPLIANCE WITH THE FDEP GENERIC PERMIT FOR STORMWATER DISCHARGE FROM LARGE AND SMALL CONSTRUCTION SITES.

THE CONTRACTOR IS RESPONSIBLE FOR ENSURING THE FOLLOWING ITEMS ARE ON SITE:

COPY OF THE STORMWATER POLLUTION PREVENTION PLAN WITH THE ORIGINAL CERTIFICATION SIGNATURES.

COPY OF THE CONTRACTOR'S EROSION CONTROL PLAN.

HAZARDOUS SPILL CONTROL PLAN WITH GUIDELINES ON CONTACTING THE 24 HOUR EMERGENCY RESPONSE PROGRAM FOR HAZARDOUS MATERIAL SPILLS. THIS SHALL INCLUDE COPIES OF DISCHARGE NOTIFICATIONS THAT HAVE OCCURRED WITHIN THE PROJECT LIMITS.

COMPLETED INSPECTION FORMS.

THE CONTRACTOR IS RESPONSIBLE FOR SUBMITTING THE FOLLOWING ITEMS
TO FLORIDA DEPARTMENT OF ENVIRONMENTAL PROTECTION IN ORDER FOR
THE NPDES PERMIT TO BE PROCESSED:

FDEP FORM 62-621.300(4XB) - NOTICE OF INTENT (NOI) TO USE GENERIC PERMIT FOR STORMWATER DISCHARGE FROM LARGE AND SMALL CONSTRUCTION ACTIVITIES. THIS NOTICE OF INTENT SHALL BE SIGNED BY THE CONTRACTOR.

THE PERMITTING FEE IS BASED ON THE PROJECTS CLEAR AND GRUB AREA
AND IS THE RESPONSIBILITY OF THE CONTRACTOR.

IT IS THE CONTRACTOR'S RESPONSIBILITY TO SUBMIT THE NOI TO FDEP NO LESS THAN 48 HOURS PRIOR TO THE START OF CONSTRUCTION. CONTRACTOR SHALL BE RESPONSIBLE FOR PROVIDING PROOF OF MAIL DATE TO THE PROJECT ADMINISTRATOR.



CITY of DELRAY BEACH
ENVIRONMENTAL SERVICES DEPARTMENT
 434 SOUTH SWINTON AVENUE, DELRAY BEACH, FLORIDA 33444
 Phone: (561) 243-7322 Fax: (561) 243-7314 www.mydelraybeach.com